



BENFICA EVENTS

TAKE YOUR EVENT
TO ANOTHER LEVEL





04 **LISBON** THE CITY THAT NEVER STOPS

SPORTS COMPLEX OF SPORT LISBOA E BENFICA

- 06 Stadium
- 18 Rooms
- 30 Press Conference
- 32 Pavilions
- 36 Centenarium Square
- 38 Synthetic turf field
- 40 Museum Auditorium

42 **CAIXA** FUTEBOL CAMPUS

INDEX





UNIQUE CHARACTERISTICS AND A STYLE OF ITS OWN

Lisbon is in the top 10 of the cities that everyone wants to visit.

Considered by many as one of the best destinations in Europe, it is a riverside city, welcoming, with a unique light and mild weather that delights those who visit the city.

With more than 500 000 inhabitants and more than 20 centuries of history, it hides history treasures on every corner, it has an enviable **musical culture**, the **Fado**, considered immaterial heritage of humanity, it has colorful and full of personality neighborhoods, amazing viewpoints and a **very lively bohemian and nightlife**.

Lisbon is irresistible. Its gastronomy does not go unnoticed. The taverns, snacks, traditional specialties, and sweets are to die for. And **football**? The intense passion with which one vibrates with every match. Patriotic supporters who applaud their favorites players.

An incredible destination, with countless possibilities to discover, visit, enjoy and surely come back.

LISBON

The city that never stops





WELCOME TO ESTÁDIO DA LUZ

A unique place capable of providing unforgettable moments. Located in Lisbon, it was inaugurated on October 25, 2003. It is a world reference, the stage for major events and events, not only in sport but also in culture and music.

It is worth highlighting that it hosted the Euro 2004 final, the 7 Wonders of the World event and the Champions League Final in 2014.

Designed by HOK, the Stadium was erected according to the principles and most innovative techniques and meets the highest safety standards and recommendations from FIFA and UEFA.

A MULTIFUNCTIONAL COMPLEX WITH SEVERAL SPACES

- Health club
- Museum
- Panoramic restaurant
- Rooms for organizing business events
- Multi-sport complex with 2 pavilions and 1 swimming pool
- Commercial area
- 2000 Parking spaces

STADIUM

Sport Lisboa e Benfica

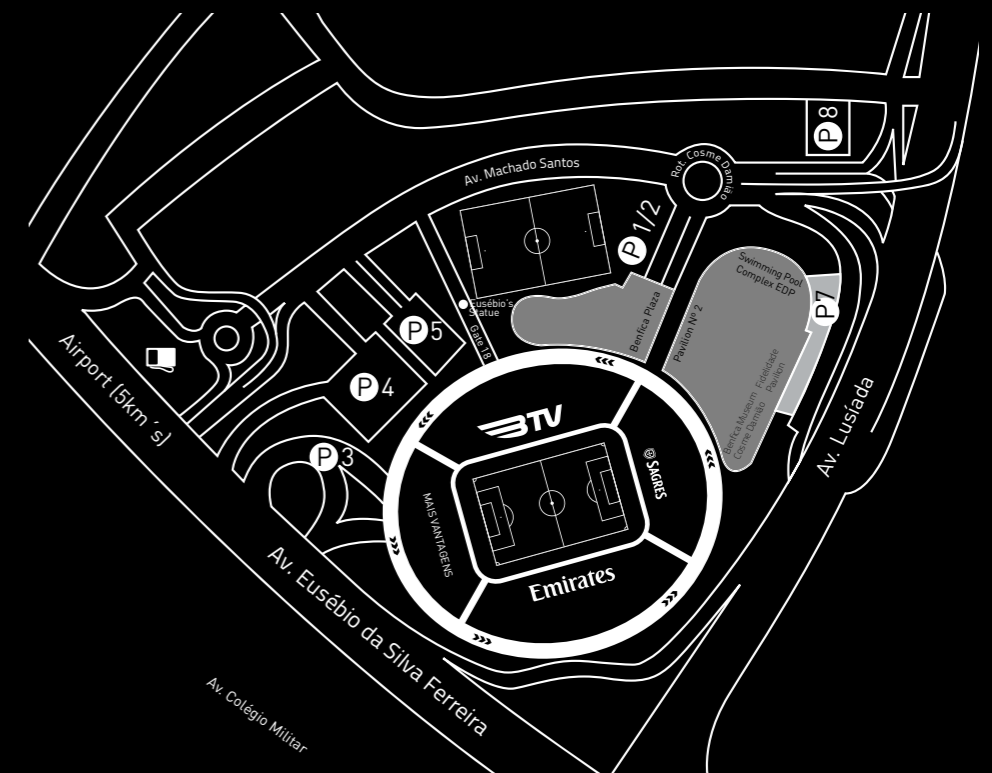



STADIUM

CAPACITY STANDS

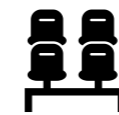

Floor 0 | **21 962**

Floor 1 | **7367**

Floor 2 | **2468**

Floor 3 | **33 035**

TOTAL | 65 012

CAPACITY TYPES OF SEATS



Public | **55 397**



Tribune of honor (main box) | **184**



VIP seats | **7367**



Box seats | **2064**

CAPACITY PARKING

(available for buses and large vehicles)



Underground | **1958**



Outdoor | **281**

HAVE YOU EVER IMAGINED CARRYING OUT AN EVENT AT ESTÁDIO DA LUZ?

The multifunctional spaces and services available make it possible to carry out from a company meeting of only 2 people to an event for 65.000 people, always with the support and commitment of Sport Lisboa e Benfica's team of professional.

We offer you **versatile spaces** with **multifunctional rooms** and equipped with the most **modern technologies**, a **service of excellence** and a **team of professionals** focused on providing you the perfect conditions for holding all types of events:

- Product presentations
 - Conferences
 - Congresses
 - Meetings
 - Seminars
 - Workshops
 - Team building initiatives
 - Cocktails
 - Stadium and Museum tours
 - Weddings
 - Concerts
 - Shooting of Advertisements
 - Football matches
- And a lot more!

EVENTS

Sport Lisboa e Benfica

**MAXIMUM ATTENTION
TO DETAIL
A MEMORABLE EVENT**

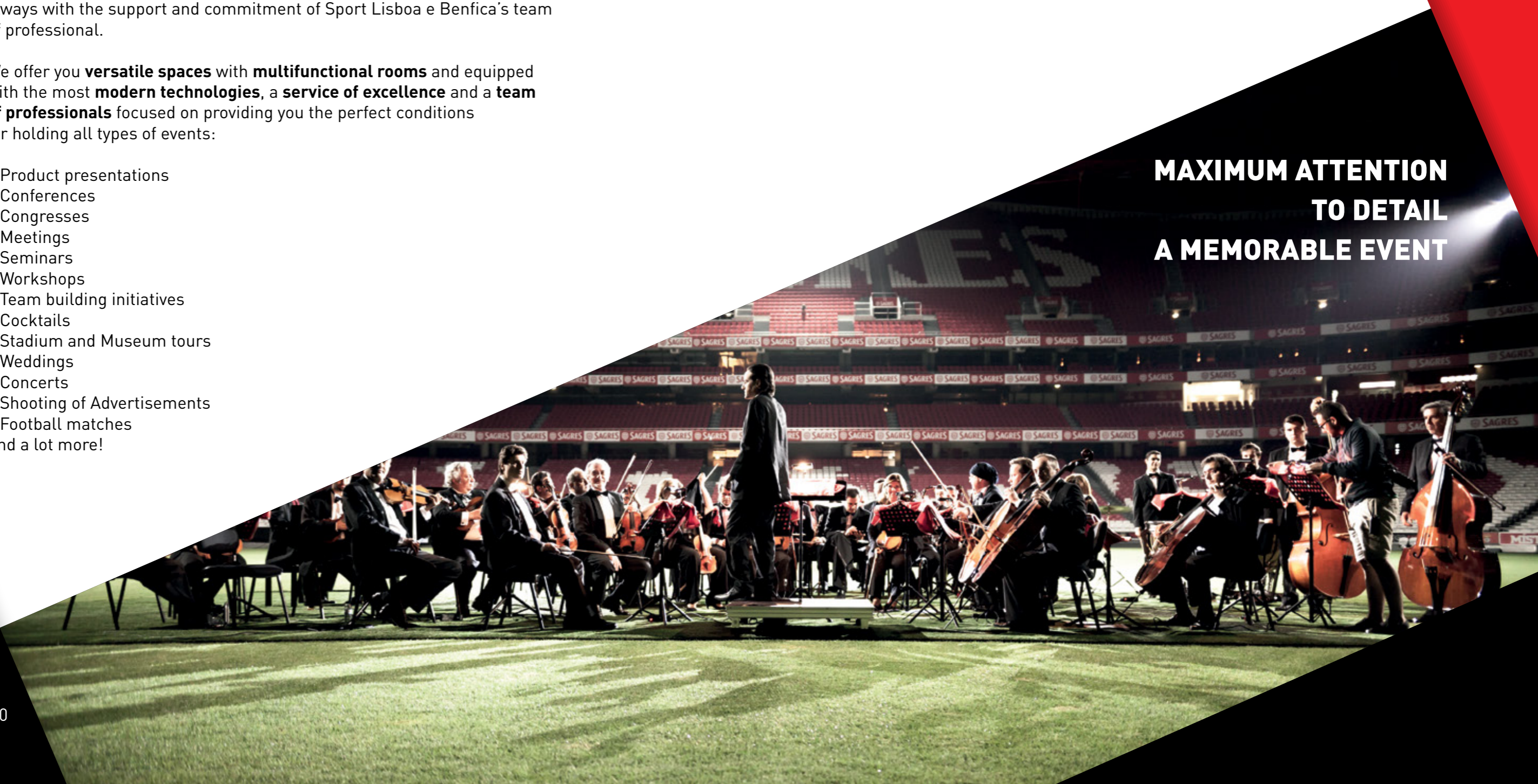

HUBLOT LOUNGE



TECHNICAL EQUIPMENT:

- Funktion-One distributed throughout the space with volume control in 4 areas;
- 1 Handheld wireless microphone;
- 1 Projection screen 244 x 137 (stage);
- 1 Video Projector 4500 lumens FULL HD (stage);
- 1 DVD player / TV tuner;
- 12 FULL HD LED monitors distributed throughout the space;
- 1 FULL HD LED monitor at the entrance;
- 1 Video rack;
- RGBW LED service, environment, and decorative lighting;
- RGBW LED control system with pre-defined colors.

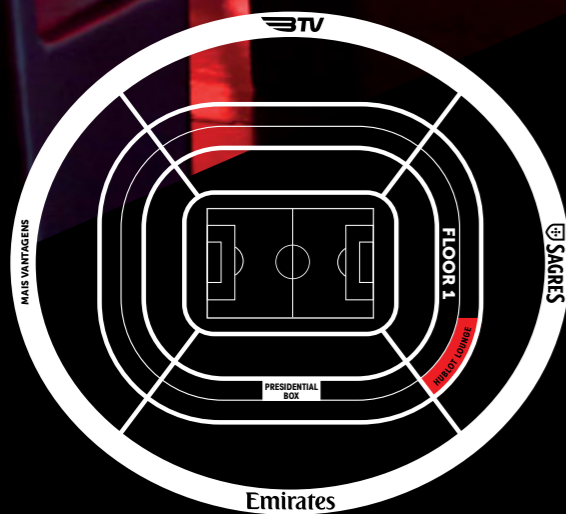

 **Room Dimensions**
16,00 x 38,00 m | 570m²

 **Ceiling height**
2,50m

 **No. of People (Sitting)**
156

 **No. of People (Standing)**
350

 **Pitch view**

 **Sanitary facilities**

 **Bar**

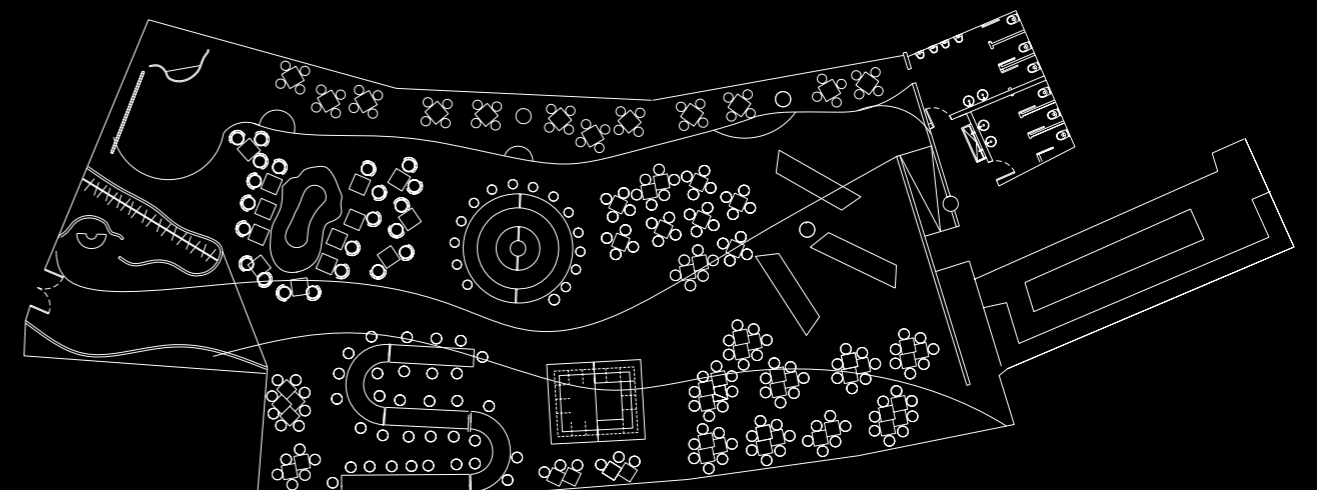

MARQUÊS LOUNGE



TECHNICAL EQUIPMENT:

- Funktion-One Audio System distributed throughout the space with volume control in 3 areas;
- 1 Handheld wireless microphone;
- 12 43" Full HD TV LED monitors in the Main room;
- 1 75" monitor in the Stage area;
- 1 43" Full HD LED monitor in the Private Room;
- Independent audio system in the Private Room;
- 1 55" Full HD TV LED monitor at the entrance;
- 1 Audio DJ table with double player;
- Video distribution system.

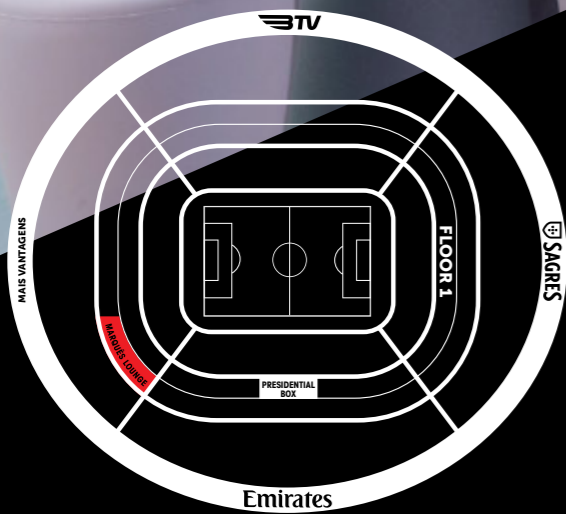

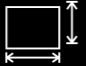
 **Room Dimensions**
16,50m x 32,00m | 600m²

 **Ceiling height**
2,70m

 **No. of People (Sitting)**
200

 **No. of People (Standing)**
250

 **Pitch view**

 **Sanitary facilities**

 **Bar**

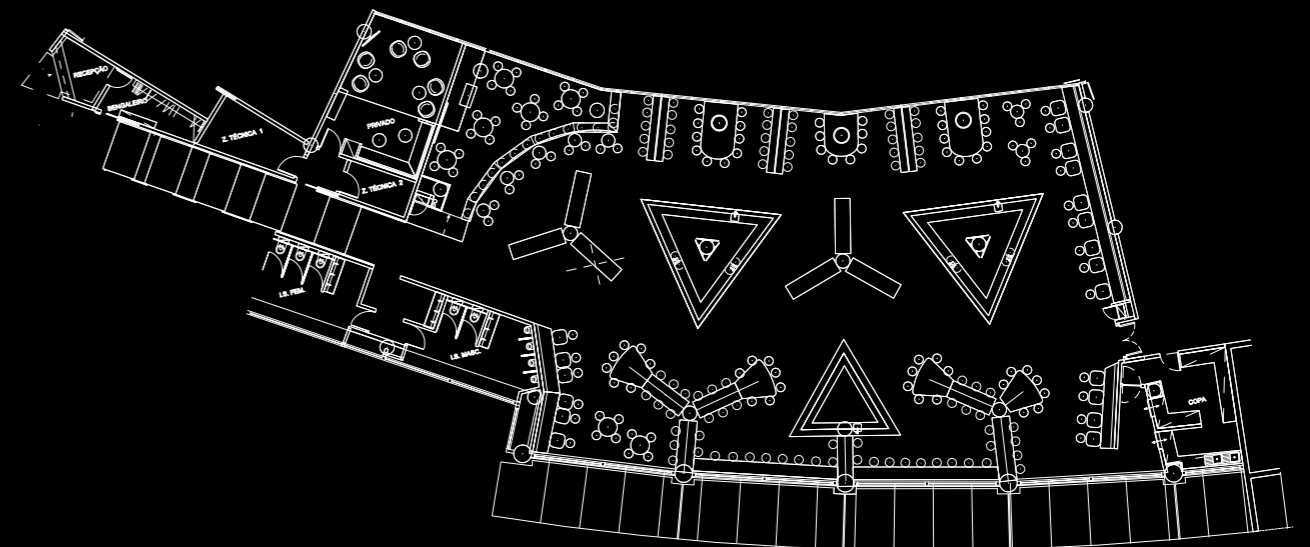

PRESIDENTIAL BOX + SUPPORT ROOM

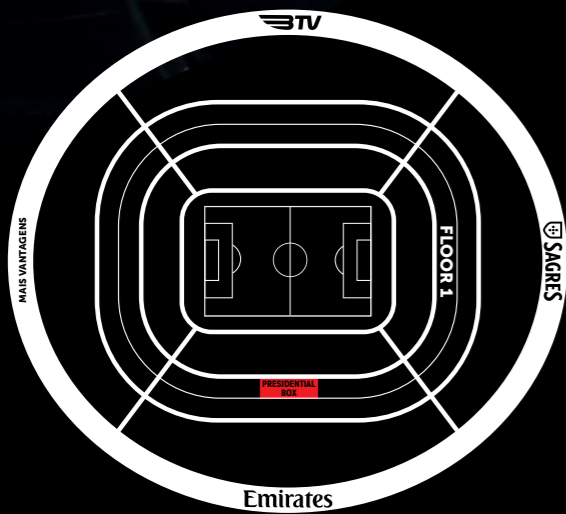
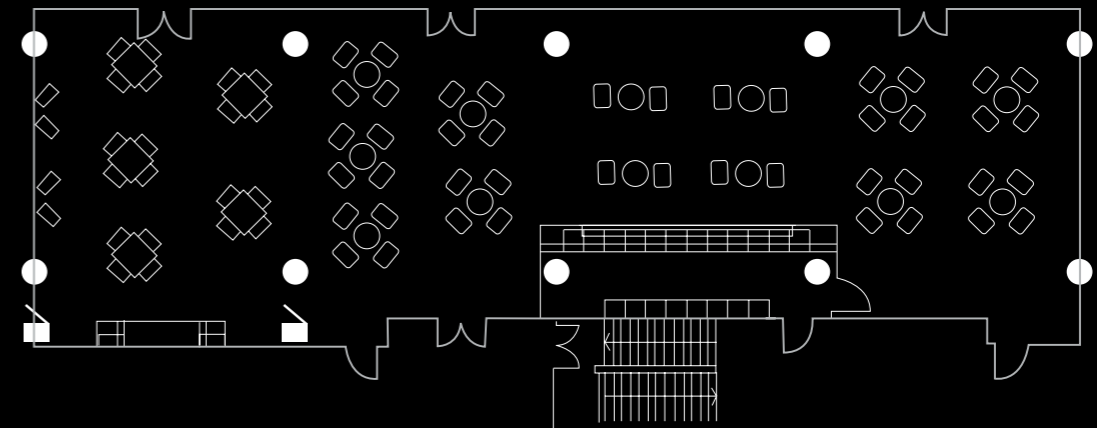

SUPPORT ROOM

 **Room Dimensions**
9.5m x 7.5m | 72m²

 **Ceiling height**
2,60m

 **Audience**
50

 **No. of People (Sitting)**
50

 **No. of People (Standing)**
70

 **Pitch view**

 **Sanitary facilities**

 **Bar**

PRESIDENTIAL BOX

 **Room Dimensions**
9.00m x 22.00m | 180m²

 **Ceiling height**
2,60m

 **Audience**
90

 **No. of People (Sitting)**
130

 **No. of People (Standing)**
160

 **Pitch view**

 **Sanitary facilities**

 **Bar**



LATIN CUP ROOM

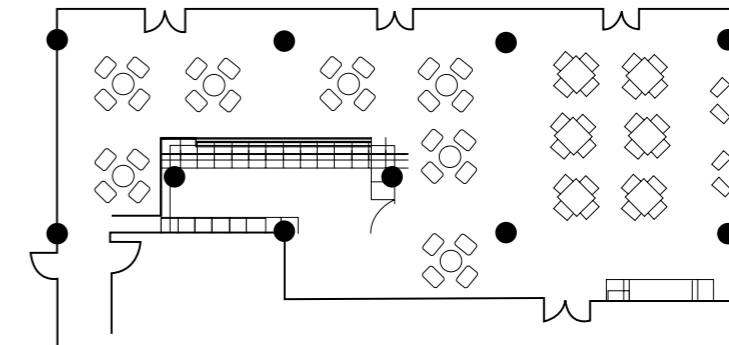

 **Room Dimensions**
9,50 x 22,00m | 165m²

 **Ceiling height**
2,60m

 **Audience**
80

 **No. of People (Sitting)**
110

 **No. of People (Standing)**
130

 **Pitch view**

 **Sanitary facilities**

 **Bar**

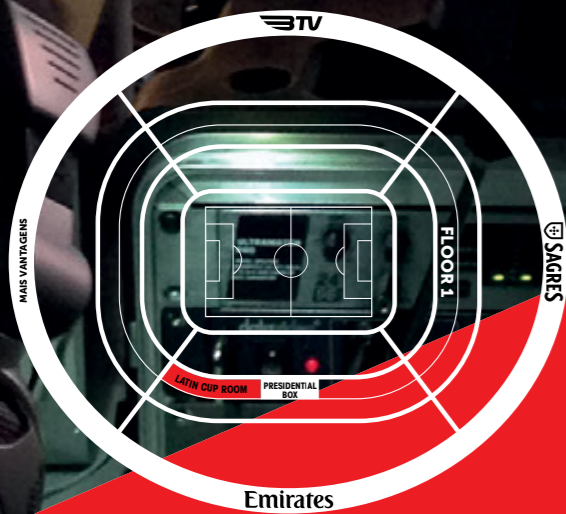



EUROPEAN CHAMPIONS ROOM

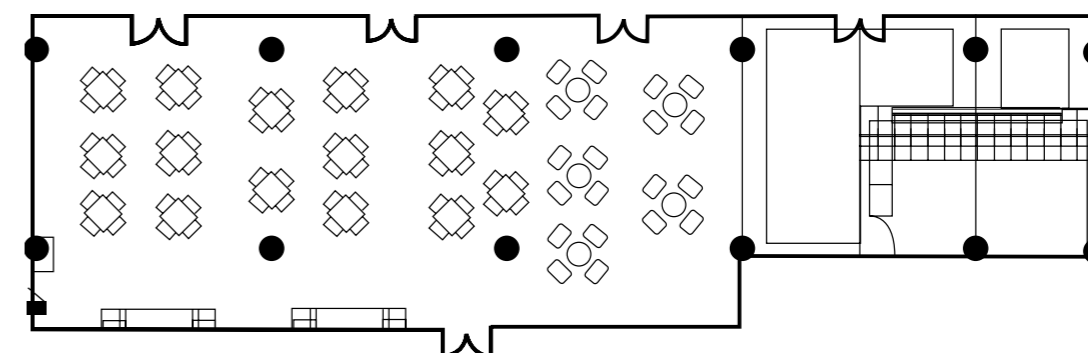

 **Room Dimensions**
9,50 x 27,00m | 272m²

 **Ceiling height**
2,60m

 **Audience**
180

 **No. of People (Sitting)**
210

 **No. of People (Standing)**
240

 **Pitch view**

 **Sanitary facilities**

 **Bar**

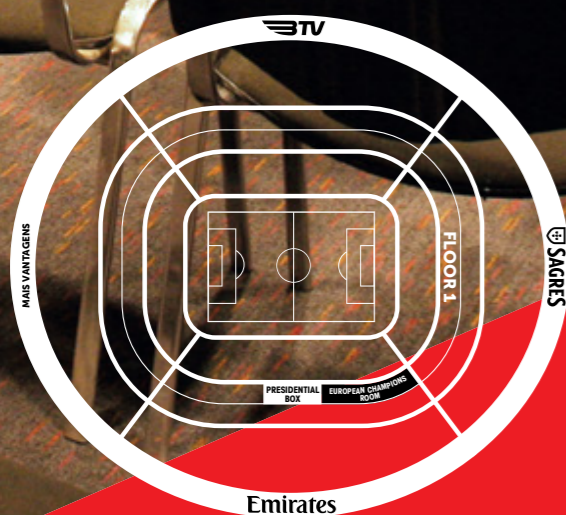



PRESIDENCIAL BOX + SUPPORT ROOM + LATIN CUP ROOM + EUROPEAN CHAMPIONS ROOM

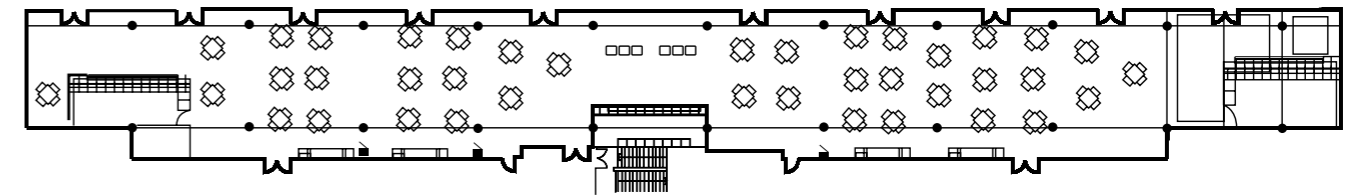

 **Room Dimensions**
9,00 x 80,00m | 700m²

 **Ceiling height**
2,60m

 **Audience**
380

 **No. of People (Sitting)**
500

 **No. of People (Standing)**
600

 **Pitch view**

 **Sanitary facilities**

 **Bar**

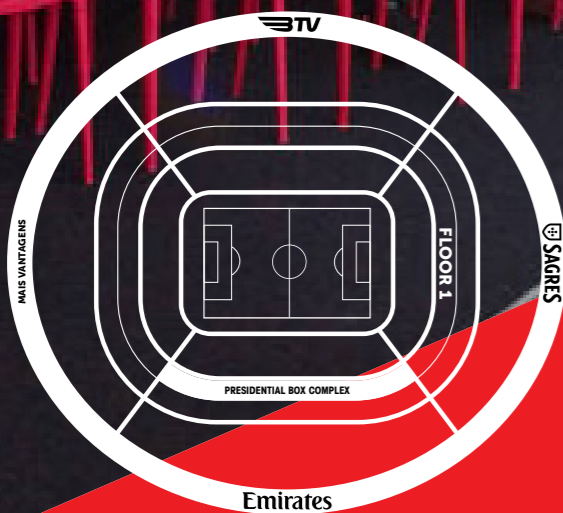

AMSTERDAM ROOM

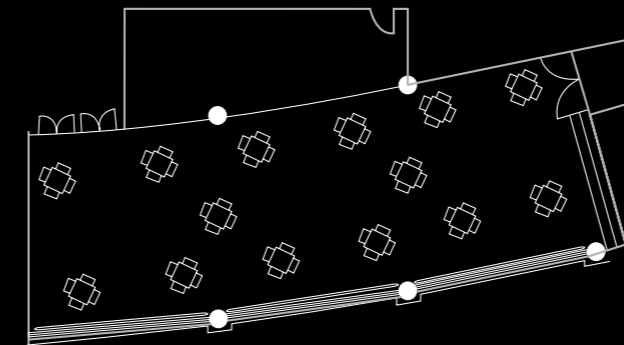

FLOOR 1

 **Room Dimensions**
6,50 x 23,00m | 185m²

 **Ceiling height**
6,20m

 **No. of People (Sitting)**
130

 **Outdoor View**

 **Sanitary facilities**

 **Bar**

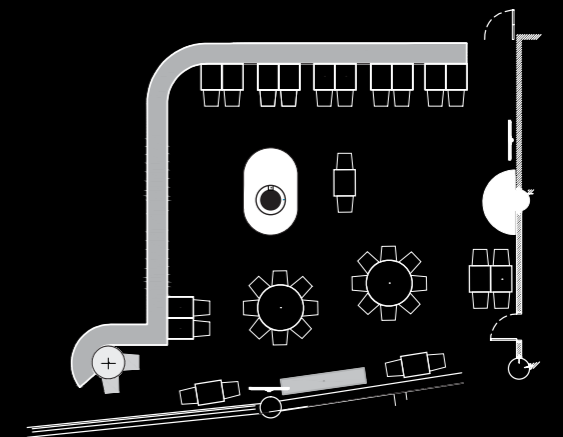

FLOOR 2

 **Room Dimensions**
11.00m x 11.00m | 132m²

 **Ceiling height**
2,50m

 **No. of People (Sitting)**
70

 **Sanitary facilities**

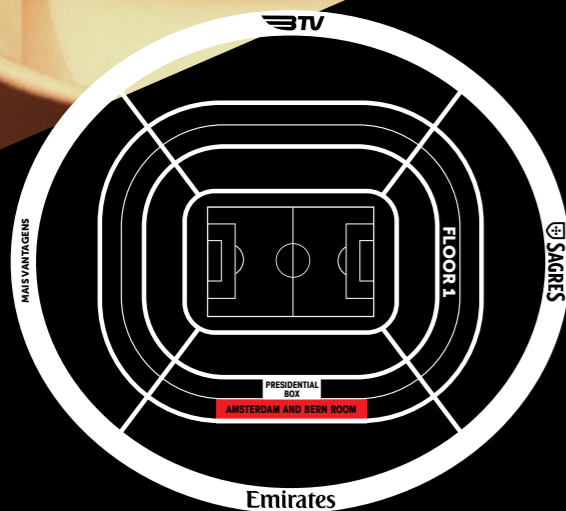

BERN ROOM

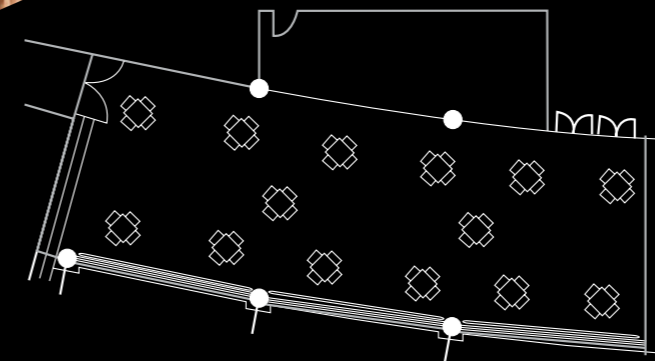

FLOOR 1

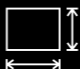
 **Room Dimensions**
6,50 x 23,00m | 185m²

 **Ceiling height**
6,20m

 **No. of People (Sitting)**
130

 **Outdoor View**

 **Sanitary facilities**

 **Bar**

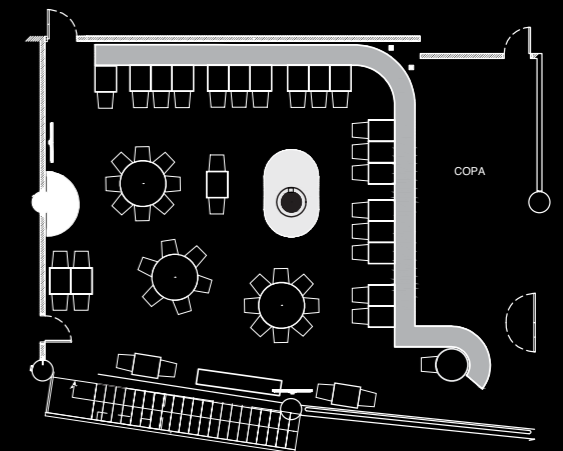

FLOOR 2

 **Room Dimensions**
11.00m x 11.00m | 132m²

 **Ceiling height**
2,50m

 **No. of People (Sitting)**
70

 **Sanitary facilities**

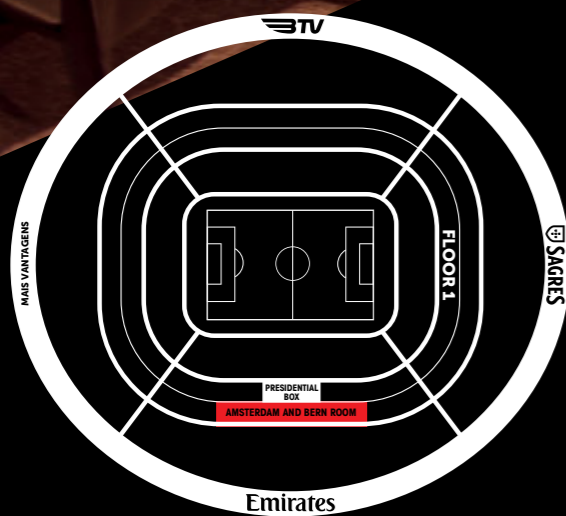



CORPORATE BAR

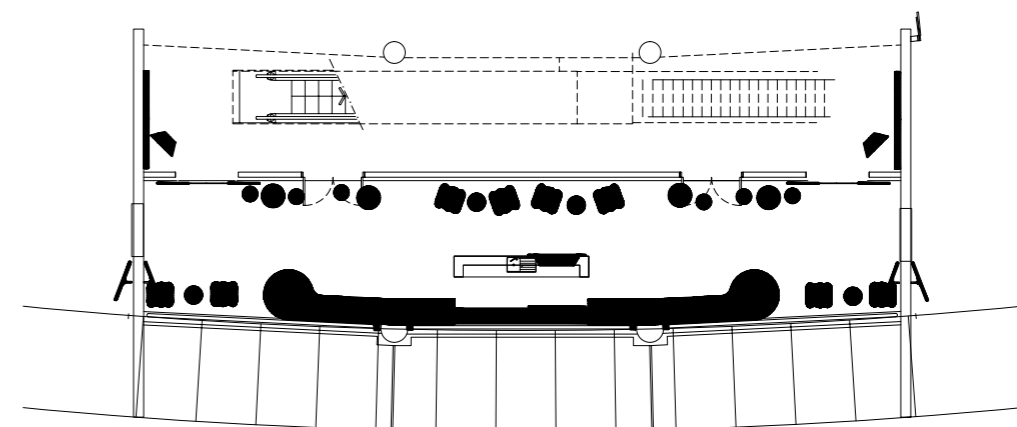

 **Room Dimensions**
4,00 x 22,00m | 88m²

 **Ceiling height**
6,20m

 **Audience**
n/a

 **No. of People (Sitting)**
n/a

 **No. of People (Standing)**
50

 **Bar**

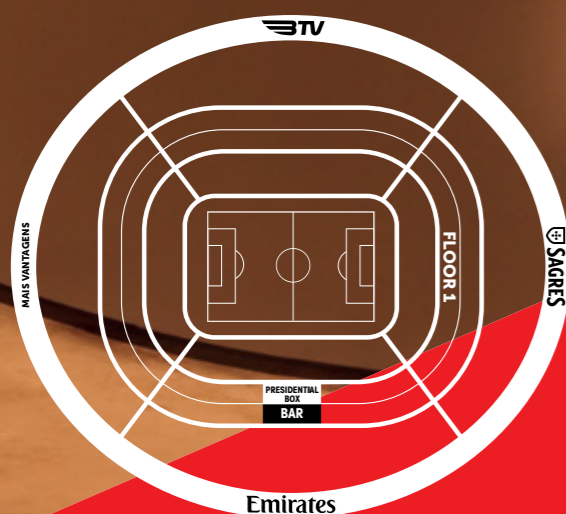



PRESS CONFERENCE ROOM

SPORT LISBOA E BENFICA



A PRESS CONFERENCE WITH THE LATEST TECHNOLOGY.

A fully equipped area, with all the conditions for conferences, presentations or seminars.

- Video Wall;
- Projector;
- Screen;
- 1 Microphone;
- Wireless;
- 4 table microphones;
- Sound system;
- DVD drive.

 **Room Dimensions**
14,00 x 17,00m | 210m²

 **Ceiling height**
3,10m a 4,30m

 **No. of People (Sitting)**
130

 **No. of People (Standing)**
170

 **Sanitary facilities**

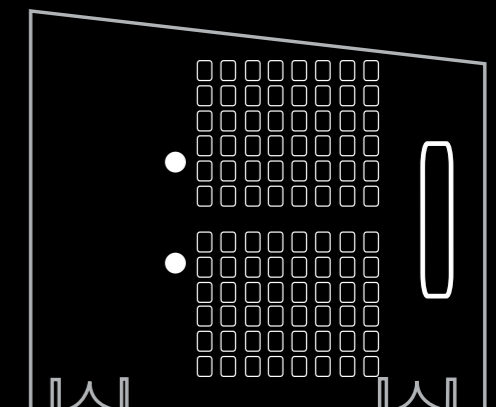



FOCUS.
LEADERSHIP.
TRAINING.

FIDELIDADE PAVILION

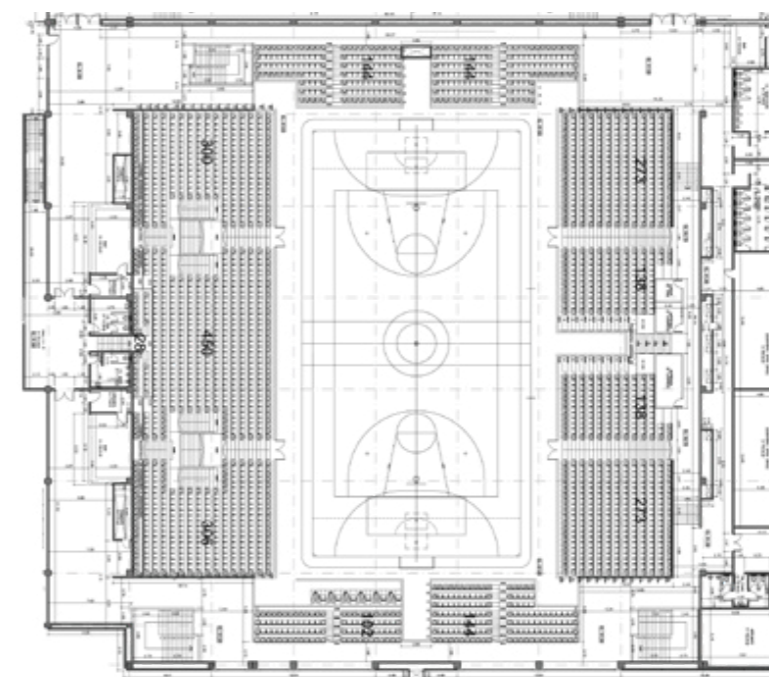

Height | **10m**



Stands | **4** Seats | **2440**



Assistance seats
and PMR seats



Dressing rooms | **5**
(2 for referees | 3 for coaches)



Mega Screens | **4**
At the pavilion's center, with sound system



Projectors | **67**



Wooden floor
with Air Gap



Bar | **5**

SPORTS COMPLEX COMPOSED BY:

- 2 pavilions and 2 swimming pools (25m and a learning one);
- Equipped rooms for media;
- Medical center;
- Anti-doping room;
- Physiotherapy and bodybuilding room.



PAVILION 2

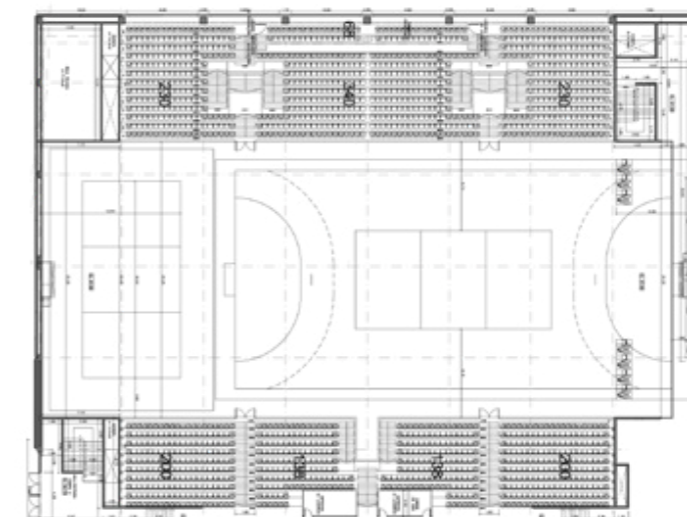

Height | 15m



Stands | 2 Seats | 1500



Assistance seats
and PMR seats



Dressing rooms | 9
(5 for teams|2 for referees|2 for coaches)



Mega Screens | 2
at the goal ends, with a sound system



Projectors | 52



Wooden floor
with Air Gap



Bar | 4

PRIDE.
VISION.
INSPIRATION.



CENTENARIUM SQUARE

**HISTORY.
HERITAGE. GLORY.**

Give voice to your event in a large
outdoor space.

10.000m²

Suitable for concerts, shows, fairs,
exhibitions, fun parks and all kind
of events.



SYNTHETIC TURF FIELD

IT WILL ALWAYS BE A UNIQUE EXPERIENCE
TO HOLD A FOOTBALL TOURNAMENT
OR A TEAM BUILDING EVENT.



Dimension Playing area
48 x 90m



Synthetic turf
Mondoturf NSF Monofibre
certified by FIFA



Football goals
Football 11, Football 7 e Football 5



Dressing rooms | **3**
(2 for teams | 1 for referees)

MUSEUM AUDITORIUM



GET INSPIRED BY
A PAST FULL OF HISTORY.
YOU WILL HAVE
A UNIQUE EVENT.

TECHNICAL EQUIPMENT:

- 1 elevated stage with 45m²;
- Soundproof room;
- Dimmable lighting;
- Air-conditioning system;
- Control room;
- HD overhead projector;
- Projection screen;
- Museum's independent entrance, with a potential reception;
- 2 boxes for simultaneous interpretation;
- 1 backoffice area/dressing room/stowage room;
- Sound;
- 4 sound speakers Funktion One R1 400w;
- 1 audio mixing console Yamaha LS9-16 - 16 vias;
- 2 handheld wireless microphones SLX2/SM58;
- 4 table microphones Gooseneck Cardioide Mx415;
- 1 PressBox with 40 Outputs Video;
- 1 Panasonic DZ570 projector with a 1920 x 1200 - 4000 Lumens resolution;
- 1 projection screen with 4 x 3m;
- Possibility to connect your computer to the projector by using HDMI or VGA ports and the audio to the room's sound system;
- Light;
- 8 dimmable led projectors for stage lighting.

 **Room Dimensions**
12,40 x 17,50m | 170m²

 **Ceiling height**
4,00m

 **Audience**
168

 **No. of People (Sitting)**
168

 **No. of People (Standing)**
n/a

 **Pitch view**
n/a

 **Sanitary facilities**

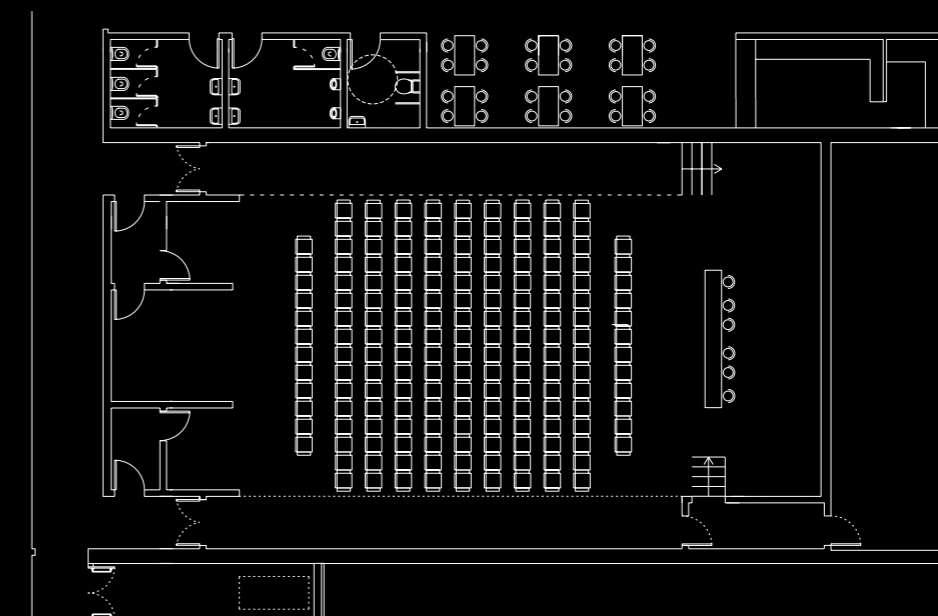



UNIQUE CHARACTERISTICS AND A STYLE OF ITS OWN

It all happens at the Sport Lisboa e Benfica Training Center.

9 football fields (3 synthetic turfs). **The main field, with natural grass**, with several dressing rooms and with artificial light, has a capacity for **2720 spectators**, with 1630 covered seats and is currently the stage for the B team matches and for the youth training of Sport Lisboa e Benfica.

To foster sports, there is a complex made up of an Hotel with 62 rooms for the Club's professional and youth training teams.

The complex also includes 3 **gyms, dressing rooms, swimming pools, jacuzzis, sauna, a canteen and a 75-seat auditorium.**

This adaptability of Caixa Futebol Campus enables to hold different kind of events such as team building initiatives on one of the pitches, Launching of products or institutional events.

CAIXA FUTEBOL CAMPUS



BENFICA

EVENTS

Estádio do Sport Lisboa e Benfica
Av. Eusébio da Silva Ferreira, 1500-313 Lisboa | Portugal
Apartado 4100, 1501 - 805 Lisboa | Portugal
T (+351) 217 219 500
(every day from 9.00am to 8.00pm)
benficaeventos@slbenfica.pt
www.slbenfica.pt/events